



# INDIUM SENSOR

Elektronische Geräte für Industrie und Umwelt

## Sunshine-duration and energy measuring head SDE 11.1

### Global radiation and sunshine duration

All direct and diffuse solar radiation reaching the surface of the earth is called global radiation. Spectral range reaches from 300nm (UVB) to about 5000nm (IR). Sunshine duration is determined in hours, with a threshold of 120W/m<sup>2</sup>.

### The global radiation sensor

The sensor is able to detect almost 90% of the solar radiation spectrum between 300 and 1100 nm (UV, VIS, IR). It measures global radiation and sunshine duration in relation to surface area.

The measuring head is suitable for use in medicine, biological research, weather information and forecast systems, in climate research and for public information in general. The measuring head type 11.1 has a weatherproof aluminum housing. The dome is made of quartz glass. The values are cosine corrected.

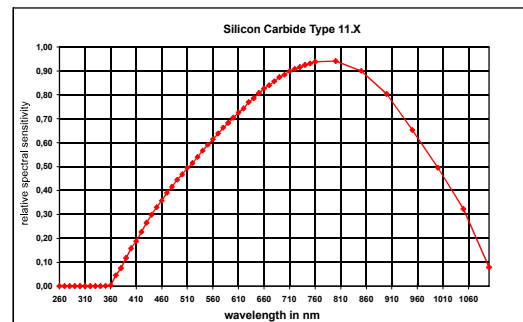

### Technical specifications

Measuring range global	0 - ca. 1300 W/m <sup>2</sup>
spectr. sensitivity	380 nm - 1100 nm
max. spectr. sensitivity	780 nm
working temperature	-20 - +60°C   -4 -140°F
signal output	2 x 0V - 5V (adjustable)
electric power	+14V - +24V /ca. 20mA
installation	2 screws M4 at bottom
connector	downward
diffusor	PTFE
cosine correction	error f2 < 3%
linearity	< 1%
abs. fault	< +/-10%
voltage (E=0)	< 10mV
dome material	blown optical glass
heading of shadow pole	<b>north</b>
weight	400g   14 oz

All specifications are subject to change without prior notice.



Dimensions:

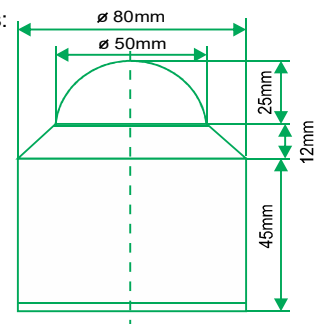

Indium Sensor  
Virchowstr. 7  
15366 Neuenhagen  
Germany  
Tel: +49(0)3342 80239  
Fax: +49(0)3342 207886