



# INDIUM SENSOR

Elektronische Geräte für Industrie und Umwelt

## Global radiation measuring head type 3.1W

### Global radiation

All diffuse and direct solar radiation reaching the surface of the earth is called global radiation.

It ranges from short (300nm (UV-B) ) to long (5000 nm (IR)) wavelength.

### Global measuring head type 3.1W

The sensor detects almost 90% of sunlight in the range of wavelength between 400 nm and 1100 nm and is covering the range of the uv-, vis- and some of the ir-light.

The measuring results are allowing conclusions about medical and biological connections by comparing to other spectral ranges.

The measuring head can be used in medical and biological research, in weather information and forecast systems, in climate research, in agriculture and for public information in general.

The measuring head type 3.1W features a weatherproof aluminum housing. The results are cosine corrected. The dome is made of polished optical glass. This device can be equipped with 4 different output signal variations.

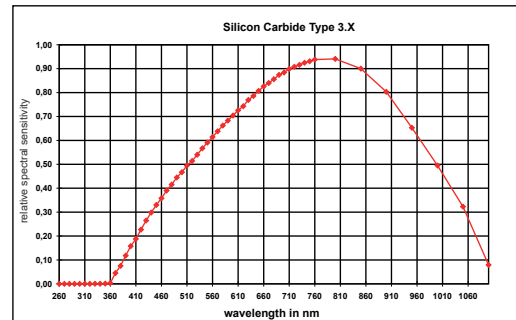

### Technical specifications

Global measuring range	0 - ca. 1300 W/m <sup>2</sup>
Spectr. sensitivity	400 nm - 1100 nm
Max. spectral sensitivity	780 nm
sensor system	silicon
Working temperature	-55 - +80°C   -70 - +170 °F
Signal output	0V - 5V/0V-10V*/
Power supply	4mA-20mA/0mA-20mA** +9V - +24V/*+14V-+24V **RL(0-100Ohm)

Installation 2 screws M4 in the bottom

Connector cable	downward
Diffusor material	PTFE
Dome material	optical Glass
Cosine correction	error f2 < 1.5%
Linearity	< 1%
Abs. error	< 10 %
Dark voltage (E=0)	< 10 mV
Weight	400g   14 oz

Specifications are subject to change without prior notice.

Dimensions:

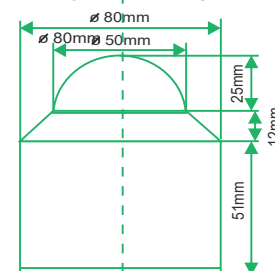

Indium Sensor  
Virchowstr. 7  
15366 Neuenhagen  
Germany  
Tel: +49(0)3342 80239  
Fax: +49(0)3342 207886