



INDIUM SENSOR

Elektronische Geräte für Industrie und Umwelt

Global radiation measuring head type 7.1

Global radiation

The complete direct and diffuse sun radiation hitting the ground is called global radiation. The spectral range extends from the short-wave range at 300 nm (UV-B) to the long-wave range at 5000 nm (IR). The radiation energy above 1000nm however is less than 10% only.

Global measuring head type 7.15

The sensor is able to detect almost 90% of the sunlight in the range between 400 nm and 1100 nm and includes UV, VIS and some of IR.

Measuring results are allowing immediate conclusions about medically and biologically relevant connections by comparing them to other spectral ranges.

The measuring head may be used in medicine, biological research, weather information and forecast systems, in climate research and for public information in general. The aluminum housing features an anodized aluminum housing suitable for indoor use. The window is made of PTFE. The values are cosine corrected.

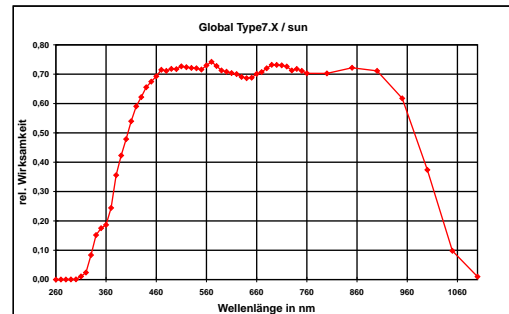

Technical specifications

| | |
|-----------------------------|-------------------------------|
| measuring range | 0 - ca. 1300 W/m ² |
| spectr. sensitivity | 400 nm - 1100 nm |
| max. of spectr. Sensitivity | 780 nm |
| sensor system | Si + filter |
| working temperature | -20°C - +60°C -4 - +140°F |
| signal output | 0V - 2V or otr. (negotiable) |
| power | +5V - +15V / <750µA |
| turn on time | < 1 s |
| turn off time | < 1 s |
| installation | 2 screws M4 in the bottom |
| connector | sideward |
| window/diffusor | PTFE |
| direction char.of rad. | error f2 < 3% |
| linearity | < 1% |
| absolute error | < 10% |
| weight | 50g 2 oz |

Specifications are subject to change without notice.

Dimensions:

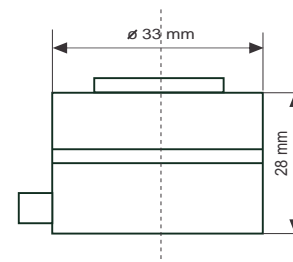

Indium Sensor
Virchowstr. 7
15366 Neuenhagen
Germany
Tel: +49(0)3342 80239
Fax: +49(0)3342 207886